



Customer Operation and Safety Guide

Rug Doctor Support: 1-800-784-3628 | www.rugdoctor.com

Machine/Tool ID:	WCTI-1 Wheelbarrow Cart
Vendor:	Tricam Industries
Vendor Website:	www.gorillacarts.com
Mfg. Support Phone No.:	1-800-867-6763

Tool Application: Heavy hauling made easy...hauls up to 600 lbs. with 7 cu.ft. of capacity and the 2-wheel design provides balanced hauling and prevents tipping. Great for moving dirt, mulch, trimmings, potting soil bags, potted plants, and much more.

Operation Guide: Read all instructions completely before you begin.

USER MUST CAREFULLY READ AND FULLY UNDERSTAND ALL INSTRUCTIONS BEFORE USING THIS WHEELBARROW.

Before operating wheelbarrow, renter agrees to fully read, understand, and follow all safety warnings and instructions set forth below, which can be found on Rug Doctor's website (www.rugdoctor.com).

USING THE WHEELBARROW

1	Inspect wheelbarrow to make sure all nuts and bolts are tight. Handles and wheels should not wobble.
2	Place wheelbarrow near material to transport and face wheelbarrow in the direction of destination.
3	Ensure route to destination is clear from obstructions. Try to avoid hilly or sloppy areas. If unavoidable, keep load small and speed slow in order to properly maintain balance of wheelbarrow.
4	Stack load in the bed of the wheelbarrow. Be careful to not overload your wheelbarrow. Load should not exceed the 600-pound capacity OR your physical strength, whichever is smaller. Overloading the wheelbarrow beyond its capacity or your physical strength may cause injury to person or damage to the wheelbarrow. For large loads, divide the load up and make several trips.
5	Evenly distribute load in wheelbarrow cart. For better weight distribution, place the heaviest part of the load over the wheels in the center and a little bit forward.
6	Lift loaded wheelbarrow by the handles. When lifting, you should be standing between the handles, feet need to be planted solidly with one slightly in front of the other. Keep your arms and back straight, and lift with your legs.
7	Push wheelbarrow to destination. Maintain a firm grip on the handles for best performance. Take care to control your speed. Don't move too quickly. If you lose control of a wheelbarrow, let go of the handles and shout a warning to others.
8	Dump load at its destination. Lift the handles until a comfortable underhand grip is achieved. Push the handles quickly forward and dump the load. In case the weight of the load is too heavy to dump, lessen it with a shovel for easy dumping. Make several trips for large loads. Don't try to carry it all at once.
9	When finished, prepare wheelbarrow for return to store. Make sure all debris is removed from the wheelbarrow cart. Wipe wheelbarrow cart and wheels down with a damp cloth. Store wheelbarrow out of the way of aisles, stairways, and emergency equipment.

Safety Guide: Read all instructions completely before you begin.

USER MUST CAREFULLY READ AND FULLY UNDERSTAND ALL INSTRUCTIONS BEFORE USING THIS WHEELBARROW.

When using wheelbarrow, basic precautions should always be followed, including the following:

- Read, understand, and follow ALL instructions and safety warnings before using this product.
- Do not exceed the overall maximum load capacity of 600 lbs.
- Wheels may scratch, dent, or damage certain types of flooring. Cover your floor prior to transporting products if applicable.
- Make sure to only put in a wheelbarrow the amount of weight you can physically handle on a hill or when turning a corner.
- When you raise and lower the handles of a wheelbarrow, treat them like any other heavy load you lift. Follow proper lifting techniques.
- Always watch out for others and also equipment or objects which might be damaged if bumped.
- Always balance the load. The load should clear safely through openings, aisles and roadways. Renter should be able to see over and around the load to guide it safely. The load should be secured, or held steady, against shifting or falling.
- Never overload and avoid loads that require excessive force to move.
- The weight rating is based on an evenly distributed load.
- Use safety attire when operating wheelbarrow, such as glove hand protection, eye protection, foot protection, and proper clothing.
- Avoid loose or baggy clothing that could trip you or get caught in the wheelbarrow's wheels.
- Do not operate the wheelbarrow when tired or under the influence of alcohol or drugs.
- Always inspect wheelbarrow prior to using. Check for damaged or broken parts and conditions that may affect its protection. If damaged or broken, immediately cease use, return wheelbarrow to rental location, and notify Rug Doctor at (800) 784-3628. Do not attempt to repair a damaged or broken wheelbarrow under any circumstances.
- Do not let children play on, stand upon or climb into wheelbarrow. Not for transporting people animals, or hazardous materials.
- Do not transport large appliances, including, without limitation, refrigerators.
- Ensure all objects, people, and animals are not obstructing the pathway.
- Be alert to terrain hazards when operating wheelbarrow. Take extra precaution if operating in wet or slippery conditions.
- Knuckle injuries are common when operating a wheelbarrow. Always take extra precautions when moving through doorways or other tight quarters.
- Stop at corners and doorways and always look before pushing forward.
- Heavy items can cause injury or damage if mishandled on the wheelbarrow. It is always best to push loads rather than pulling them, keeping knees slightly bent and your back straight, so your legs, not your back, do the work.
- Avoid walking backwards, unless you need to maneuver in a tight space.
- Never try to lift more than you can manage safely. If you have any back or knee issues, please consult with your physician prior to using.
- Keep children and others at least 25 feet away during loading and unloading.
- This product is not intended for use by persons under the age of 18.
- Ensure loads are within the wheelbarrow cart to safely negotiate the wheelbarrow's pathway.
- Avoid steep inclines/slopes.
- Do not return wheelbarrow with any debris left in the wheelbarrow. Wheelbarrow cart and wheels must be thoroughly wiped down with a damp cloth prior to return to rental location.
- KEEP THESE INSTRUCTIONS FOR FURTHER REFERENCE.

 **WARNING** This product can expose you to chemicals including Di(2-ethylhexyl)phthalate (DEHP), which is known to the State of California to cause birth defects or other reproductive harm, and lead, which is known to the State of California to cause cancer, birth defects, and other reproductive harm. For more information, go to www.P65Warnings.ca.gov.

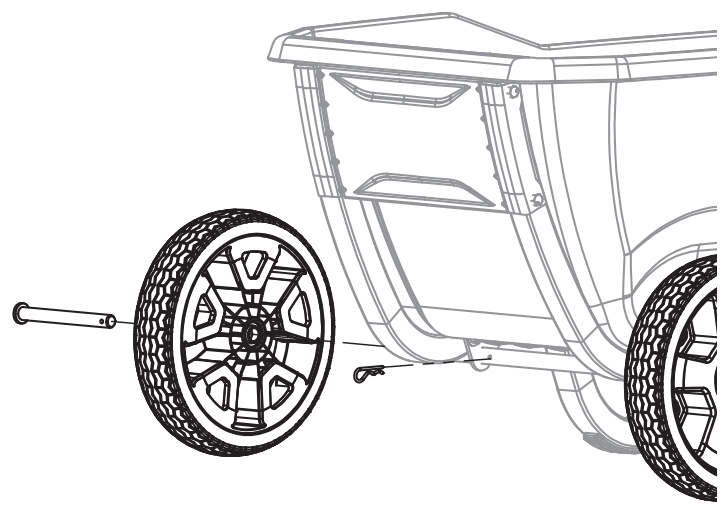
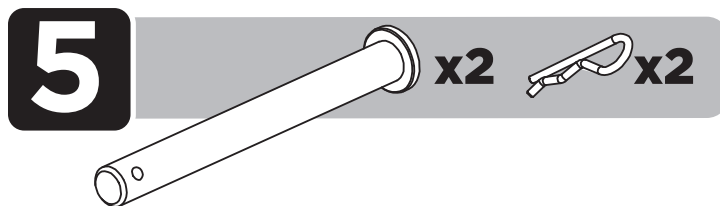

QUESTIONS, PROBLEMS, OR MISSING PARTS?

If any parts are missing, damaged, or if you have any questions or need additional instructions, **DO NOT RETURN THIS PRODUCT TO THE RETAILER**, visit us at www.gorillacarts.com to complete the replacement parts submission form or call our customer service department at 1-800-867-6763. 9 a.m. - 4 p.m., CST, Monday-Friday.

IMPORTANT SAFETY INSTRUCTIONS

1. Read, understand and follow ALL instructions and safety warnings before using this product.
2. Do not exceed the overall maximum load capacity of 600 lbs. The weight rating is based on an evenly distributed load.
3. Use safety attire when operating cart, such as glove hand protection, eye protection, foot protection and proper clothing.
4. Do not operate the cart when tired or under the influence of alcohol or drugs.
5. Always inspect cart prior to using. Check for damaged or broken parts and conditions that may effect its protection.
6. Replace or repair damaged or worn parts immediately.
7. Do not let children play on, stand upon or climb into cart. Not for transporting people or animals.
8. Do not overload, avoid loads that require excessive force to move.
9. Be alert to terrain hazards when operating the cart.
10. Do not over stack the load, maintain visibility and load stability.
11. Ensure loads are within the cart to safely negotiate the carts pathway.
12. Avoid steep inclines/slopes.
13. KEEP THESE INSTRUCTIONS FOR FURTHER REFERENCE.

Gorilla Carts®
7677 Equitable Drive
Eden Prairie, MN 55344
1-800-867-6763 • www.gorillacarts.com

181102A

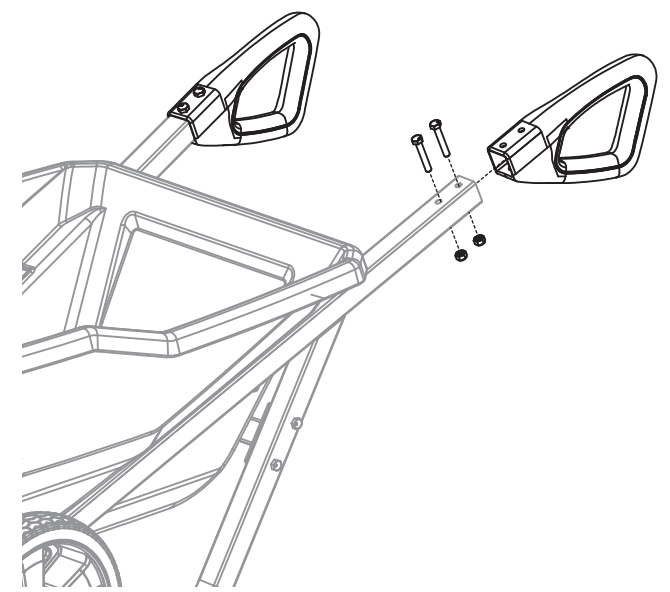

¿PREGUNTAS, PROBLEMAS O PIEZAS FALTANTES?

Si falta alguna pieza o si tienes preguntas o necesitas instrucciones adicionales, **NO DEVUELVAS ESTE PRODUCTO AL MINORISTA**, visítanos en Internet en www.gorillacarts.com para llenar el formulario de piezas de repuesto o llama a nuestro departamento del servicio del cliente al 1-800-867-6763. 9 a.m. a 4 p.m., Hora Estándar del Centro, de Lunes a Viernes.

INSTRUCCIONES DE SEGURIDAD IMPORTANTES

1. Lea, comprenda y siga TODAS las instrucciones antes de utilizar este producto.
2. No exceda la capacidad de carga total máxima de 272 kg. La clasificación de peso está basada en una carga distribuidas uniformemente.
3. Al operar este carrito usa guantes para proteger las manos, medios de protección visual y de los pies, así como ropa adecuada para mantener la seguridad.
4. No uses el carrito si estás cansado o bajo la influencia de drogas o alcohol.
5. Revisa siempre el carrito antes de usarlo. Verifica que no haya piezas dañadas o rotas, ni problemas que afecten su funcionamiento.
6. Reemplaza o repara inmediatamente las piezas dañadas o gastadas.
7. No dejes que los niños jueguen, se paren o se suban en el carrito. No usar para transporte de personas o animales.
8. No sobrecargues ni coloques pesos que requieran fuerza excesiva para mover.
9. Mantente alerta para evadir riesgos en el terreno al operar el carrito.
10. No apiles demasiados objetos al cargar; mantén la visibilidad y estabilidad de la carga.
11. Asegura que la carga no sobresalga del carrito para trasladarla de forma segura por la ruta correspondiente.
12. GUARDA ESTAS INSTRUCCIONES PARA FUTURAS CONSULTAS.



MODEL# GCR-7

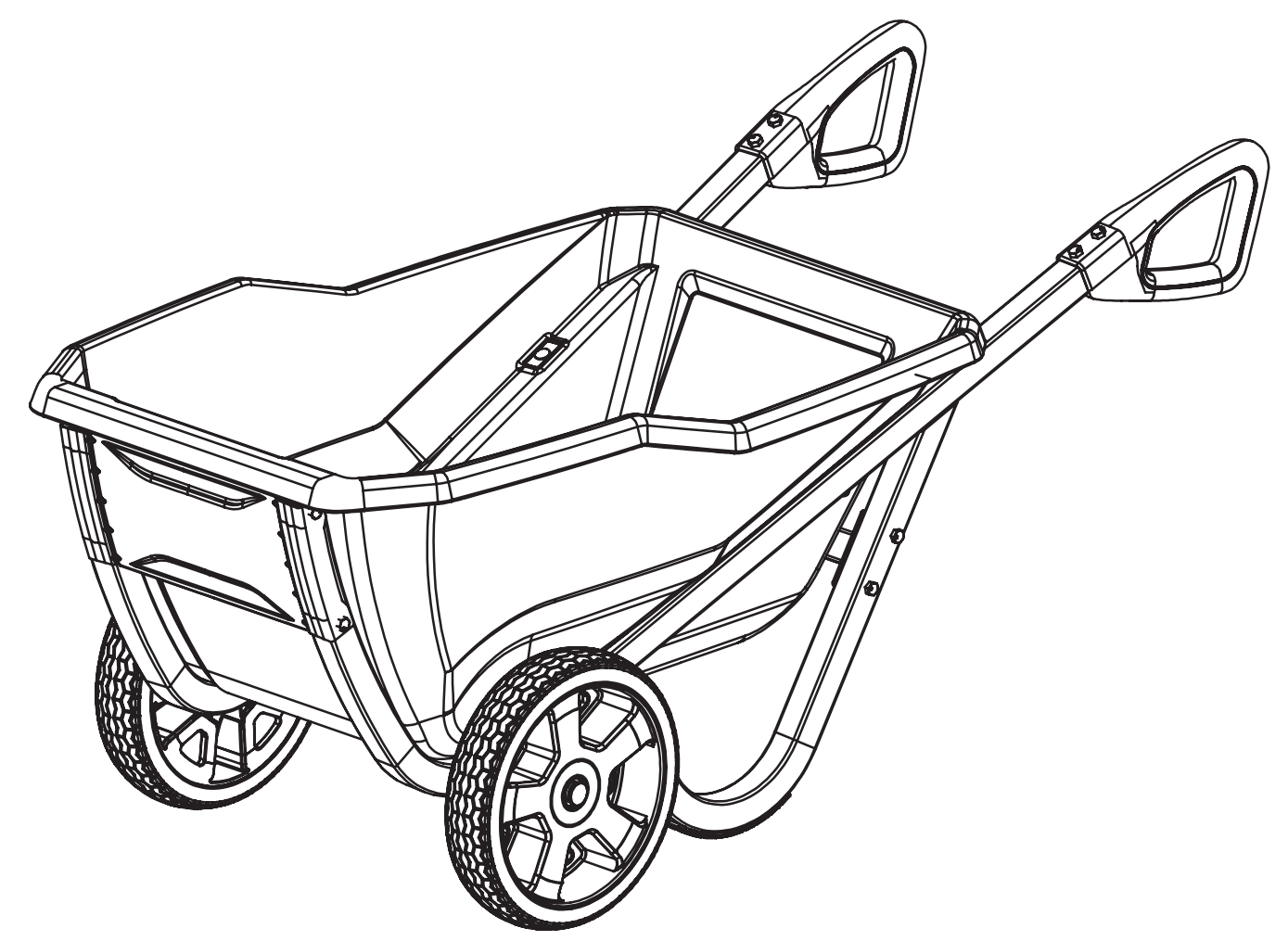

Gorilla Carts® are covered by several issued and pending US and international patents. For more information, please visit www.gorillacarts.com/patents
Gorilla Carts® está amparada por varias patentes internacionales y de Estados Unidos ya concedidas o en trámite. Para más información, visita www.gorillacarts.com/patents

1 OF 2

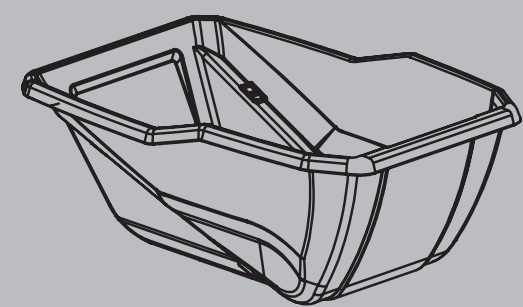

2 OF 2

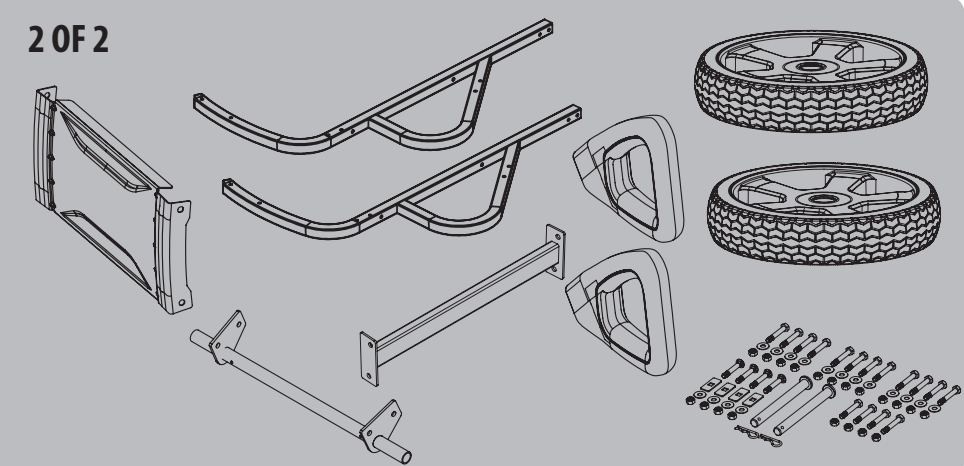

HARDWARE • Herrajes

STEP 1
Paso 1

STEP 2
Paso 2

STEP 3
Paso 3

STEP 4
Paso 4

STEP 5
Paso 5

STEP 6
Paso 6

TOOLS REQUIRED • Herramientas necesarias

13mm x2

ASSEMBLY INSTRUCTIONS

Instrucciones de Ensamblaje

1 x4 x4 x4

2 x4 x4 x4

3 x4 x4 x4

4 x4 x4 x4 x4